



bissinger

Anschlusskabel, Adapter, Neutralelektroden

Cables, Adapters, Neutral electrodes

Câbles, Adapteurs, Electrodes neutres

Cables, Adaptadores, Electrodos neutros







Cavi, Adattatori, Elettrodi neutri



Focus on better solutions

Monopolare Kabel
Monopolar cables
 Câbles monopolaires
Cables monopolares
 Cavi monopolari

Stecker generatorseitig
Plug, generator side
 Connecteur, côté générateur
Enchufe, lado del generador
 Spina, lato generatore

								
		Ø4 mm Buchse Socket Douille Zócalo Bussola	Ø4 mm Buchse gewinkelt Socket, angled Douille, coudée Zócalo acodado Bussola ad angolo	Ø2 mm Stecker geschützt für Resektoskop Plug, protected for resectoscope Connecteur protégé pour résectoscope Enchufe protegido para el resectoscopio Spina protetta per resettoscopio	Ø4 mm Stecker geschützt Plug, protected Connecteur protégé Enchufe protegido Spina protetta	Ø3 mm Buchse Socket Douille Zócalo Bussola	Ø4 mm Buchse mit Sechskant Hexagon socket Douille hexagonale Zócalo con hexágono Bussola con esagono	Ø4 mm Stecker* Plug* Connecteur* Enchufe* Spina*
Erbe T-Serie, Martin, Berchtold	3m	80100014	80100240	80100314	-	80100319	80100315	80100214
	5m	80100016	, \$\$\$\$& %	80100324	-	-	-	80100216
Bovie, Valleylab, Conmed	3m	80100215	80100242	80100320	80100220	, \$\$\$\$ &&	-	80100217
	5m	80100221	, \$\$\$\$()	80100340	80100222	-	-	80100218
Martin, Berchtold, Aesculap	3m	80100031	-	80100316	80100230	-	-	80100212
	5m	80100331	-	80100326	-	-	-	-
Erbe ACC/ICC, VIO	3m	80100114	80100243	80100330	-	-	80100318	-
	5m	80100115	-	80100360	-	80100317	-	-

*Entspricht nicht
 EU-Bestimmungen
***Non-compliant
 with EU standards**
 *Non conforme
 aux normes UE
***No cumple
 las normas UE**
 *Non conforme
 alle norme UE





Aufbau bipolare Kabel
Bipolar cable structure
 Structure des câbles bipolaires
Construcción del cable bipolar
 Struttura dei cavi bipolari

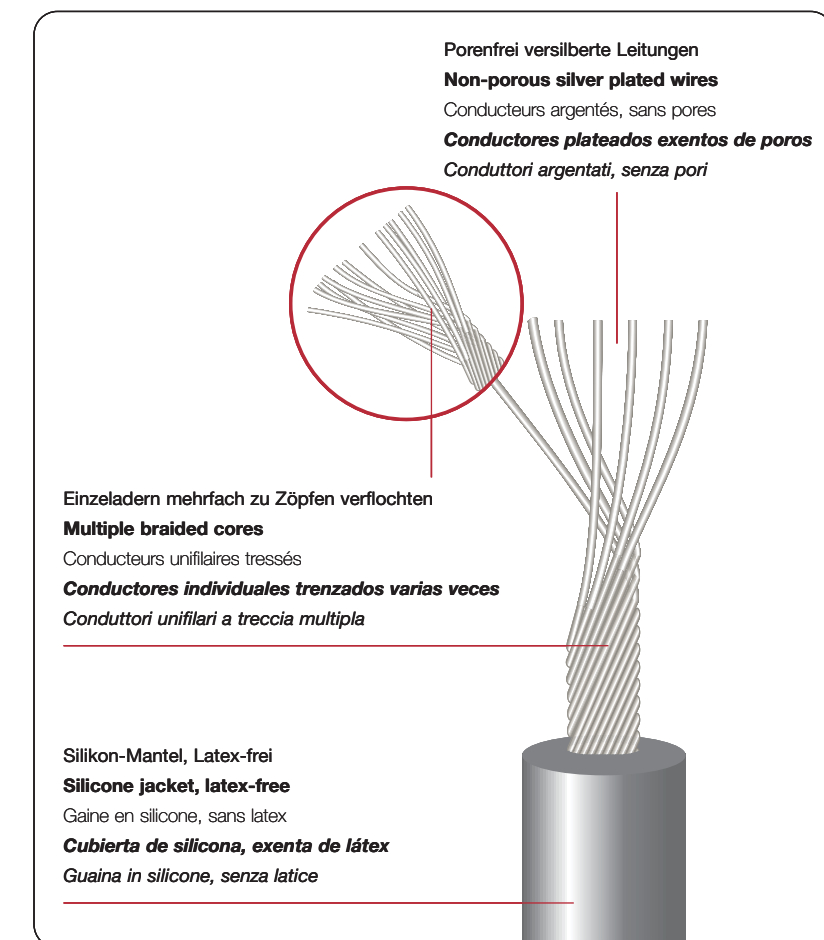

Aufbau monopolare Kabel
Monopolar cable structure
 Structure des câbles monopolaires
Construcción del cable monopolar
 Struttura dei cavi monopolari



Kabel für Einmal-Neutralelektroden
Cables for disposable neutral electrodes
 Câbles pour électrodes neutres à usage unique
Cable para electrodos neutros desechables
 Cavi per elettrodi neutri monouso

 <p>Stecker für Einmal-Neutral-Elektroden Plug for single-use electrodes Connecteur pour électrodes neutres à usage unique Enchufe para electrodo desechable Spina per elettrodi neutri monouso</p>		
<p>Stecker generatorseitig Plug, generator side Connecteur, côté générateur Enchufe, lado del generador Spina, lato generatore</p>		
 <p>Erbe, Integra KLS Martin</p>	4,5 m	89101050
 <p>KLS Martin</p>	4,5 m	89101052
 <p>Valleylab, Conmed Erbe (international)</p>	4,5 m	89101051
 <p>Valleylab (Non REM), Conmed, Erbe (international)</p>	4,5 m	89101053

Wiederverwendbare Neutralelektroden
Reusable neutral electrodes
 Electrodes neutres réutilisables
Electrodos neutros reutilizables
 Elettrodi neutri riutilizzabili

Die wiederverwendbaren Neutralelektroden von Bissinger bestehen aus leitfähigem, widerstandsfähigem Silikon und sind mit einem 4 m Anschlusskabel ausgestattet.

The reusable neutral electrodes by Bissinger are made of conductive resistant silicone and are equipped with a 4 m connecting cable.

Les électrodes neutres réutilisables de Bissinger sont faites de silicone conductrice résistante et dotées d'un câble de raccordement de 4 m.

Los electrodos neutros reutilizables de Bissinger se componen de silicona conductiva y resistente y están equipados con un cable de conexión de 4 m.

Gli elettrodi neutri riutilizzabili della Bissinger sono fatti da silicone conduttivo e resistente e sono muniti di un cavo di collegamento di 4 m.

Wisch- oder Sprühdesinfektion
Wipe or spray disinfection
 Désinfection par essuyage ou pulvérisation
Desinfección por lavado o rocío
 Disinfezione mediante pulizia o con spray

*Entspricht nicht EU-Bestimmungen
 *Non-compliant with EU standards
 *Non conforme aux normes UE
 *No cumple las normas UE
 *Non conforme alle norme UE



Kontaktfläche 390 cm² (15 x 26 cm), für Erwachsene
Contact surface 390 cm² (15 x 26 cm), for adult
 Surface de contact 390 cm² (15 x 26 cm), pour adultes
Superficie de contacto 390 cm² (15 x 26 cm), para adultos
 Superficie di contatto 390 cm² (15x26 cm), per adulti

Stecker generatorseitig
Plug, generator side
 Connecteur, côté générateur
Enchufe, lado del generador
 Spina, lato generatore

 <p>Erbe, Integra KLS Martin</p>	89242004*
 <p>KLS Martin</p>	89242003*
 <p>Valleylab (Non REM), Conmed, Erbe (international)</p>	89242005*



Kontaktfläche 128 cm² (8 x 16 cm), für Kinder
Contact surface 128 cm² (8 x 16 cm), for children
 Surface de contact 128 cm² (8 x 16 cm), pour enfants
Superficie de contacto 128 cm² (8 x 16 cm), para niños
 Superficie di contatto 390 cm² (15x26 cm), per bambini

Stecker generatorseitig
Plug, generator side
 Connecteur, côté générateur
Enchufe, lado del generador
 Spina, lato generatore

 <p>Erbe, Integra KLS Martin</p>	89232004*
 <p>KLS Martin</p>	89232003*
 <p>Valleylab (Non REM), Conmed, Erbe (international)</p>	89232005*

Bipolare Adapter

Bipolar adapters

Adaptateurs bipolaires

Adaptadores bipolares

Adattatori bipolari



89102000

Martin Generator
Martin generator
Générateur Martin
Generatore Martin
Generador Martin



89102001

Erbe Generator
Erbe generator
Générateur Erbe
Generatore Erbe
Generador Erbe

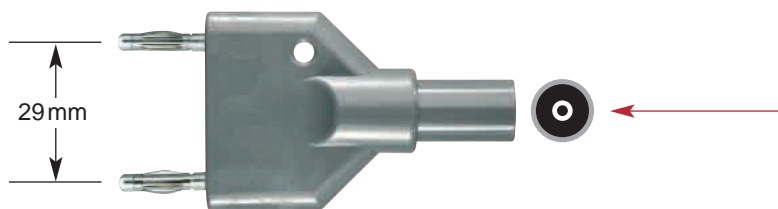

89102002

Martin Kabel
Martin cable
Câble Martin
Cavo Martin
Cable Martin

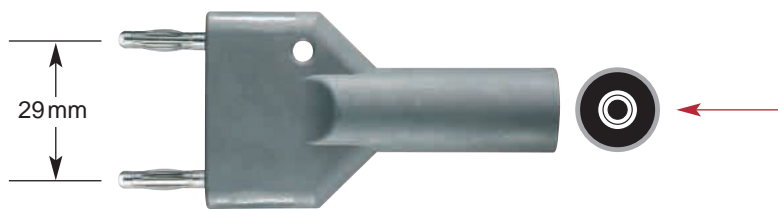

89102003

Erbe Kabel
Erbe cable
Câble Erbe
Cavo Erbe
Cable Erbe

Monopolare Adapter

Monopolar adapters

Adaptateurs monopolaires

Adaptadores monopolares

Adattatori monopolari



89102004

Martin Generator
Martin generator
Générateur Martin
Generatore Martin
Generador Martin



89102005

Erbe Generator
Erbe generator
Générateur Erbe
Generatore Erbe
Generador Erbe